

# CORNER RESTORATION

CORNER: SW SEC. 4, TWP. 13 S., RANGE 33 E., W.M.

ORIGINAL SURVEY BY: John B. David

CONTRACT NUMBER: 131

CONTRACT DATE: June 8, 1869

**SUBSEQUENT SURVEYS:**

- ▶ By Robert Bagett, County Surveyor in 1988

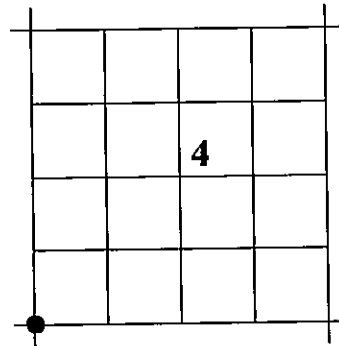

**ORIGINAL GLO DESCRIPTION:** set stone 18"x10"x8" for corner to sections 4, 5, 8 and 9

- ▶ 1988: Corner was remonumented by Bagett with a County Surveyor brass cap. His record states: *I found the original basalt stone 15x10x10 inches, marked with 3 grooves and 2 grooves at a rockjack at the corner of fence lines running North, East and West. I accept the position of this stone and fence corner as the best available evidence of this corner. This position is harmoniously related to other found corners in the area. At the corner point: Set a 1½"x30" Galv. iron pipe 26" in the ground with attached brass cap marked as shown. From which I set NEW REFERENCE POINTS:*

*A 5/8"x30" iron pin driven flush with the ground, bears N.45°E., 30.00 ft. with attached 1½" Alum Cap, marked Grant County Surveyor RP1 1988.*

*A 5/8"x30" iron pin driven flush with the ground, bears S.45°E., 30.00 ft. with attached 1½" Alum Cap, marked Grant County Surveyor RP2 1988.*

*A 5/8"x30" iron pin driven flush with the ground, bears S.45°W., 30.00 ft. with attached 1½" Alum Cap, marked Grant County Surveyor RP3 1988.*

*A 5/8"x30" iron pin driven flush with the ground, bears N.45°W., 30.00 ft. with attached 1½" Alum Cap, marked Grant County Surveyor RP4 1988.*

*Buried Stone South and alongside iron pipe.*

**EVIDENCE FOUND AND NEW ACCESSORIES:** Found a 1½" iron pipe with attached Grant County Surveyor brass cap, marked as shown below. I found the reference points set by Bagett in 1988 in good condition.

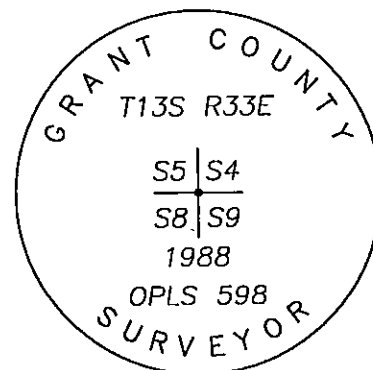

**STATE PLANE COORDINATES (3601 OR N)**

Reference Datum: NAD83 From OPUS solution

Northing: 294,540.6 ft.

Easting: 8,657,029.4 ft.

Ellip. Ht: 3,598.5 ft.

**RESTORATION BY, STAMP AND DATE:**

Michael C. Springer, Grant County Surveyor

RECEIVED AND FILED  
GRANT COUNTY SURVEYOR

SEP 19 2012

BY: 

REGISTERED  
PROFESSIONAL  
LAND SURVEYOR

  
OREGON  
JULY 9, 2002  
MICHAEL C. SPRINGER  
#70918

EXPIRES: 6/30/2014

Surveyed September 16, 2012